



"PLEASE DRIVE SAFELY"

LASALLE COUNTY HIGHWAY DEPARTMENT

DONALD R. ERNAT, COUNTY ENGINEER

1400 N. 27TH ROAD - P.O. BOX 128 - OTTAWA, ILLINOIS 61350

PHONE (815) 434-0743 FAX (815) 434-0747

MEMORANDUM

ADDENDUM #1

DATE: July 9, 2024
TO: All Bidders
FROM: Donald R. Ernat
SECTION: 24-14865-00-DR, Grand Rapids Township

The following correction should be made to the bid documents:

1. Replace Plan Sheet 5 of 10 with the attached REVISED. The profile view has been added.
2. Replace Plan Sheets 9 & 10 of 10 with the attached REVISED. The cuts & fills have been added.

Please make the above referenced changes and include this Addendum in your proposal as acknowledgment of its receipt.

Donald R. Ernat, P.E.
County Engineer

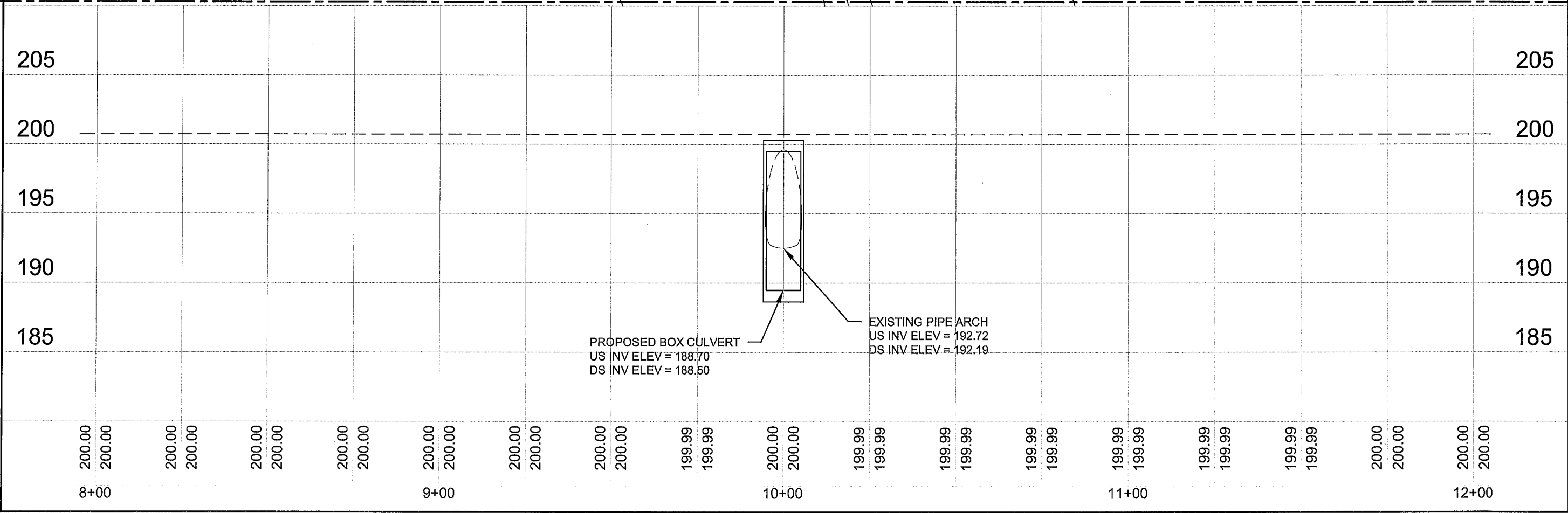
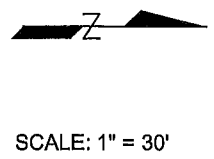
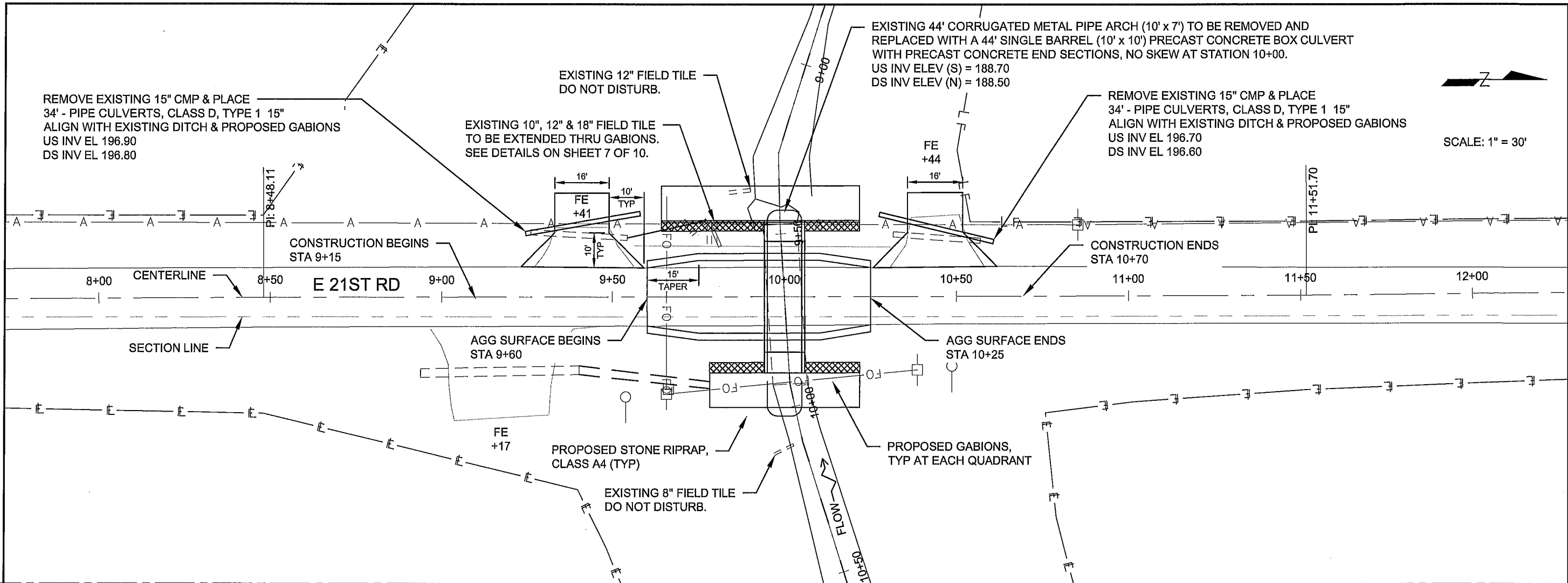

SECTION
 24-14865-00-DR
 PLAN AND PROFILE
 LASALLE COUNTY
 HIGHWAY DEPARTMENT
 1400 N. 27TH ROAD - P.O. BOX 128 - OTTAWA, ILLINOIS 61350
 PHONE (615) 434-0743 FAX (615) 434-0747
 PLEASE DRIVE SLOWLY
 HWY. NO.
 E 21ST RD
 SHEET NO.
 5 of 10

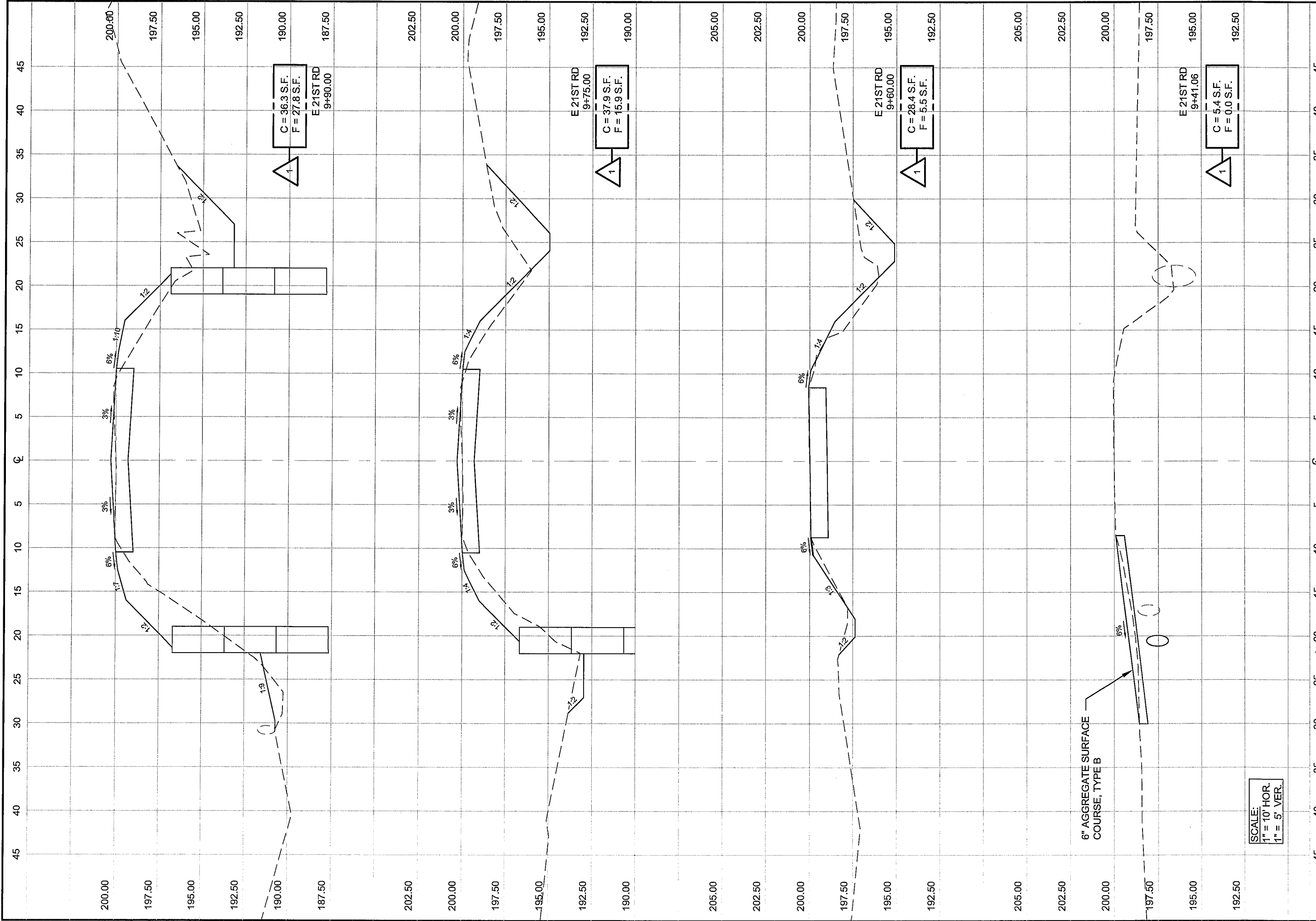

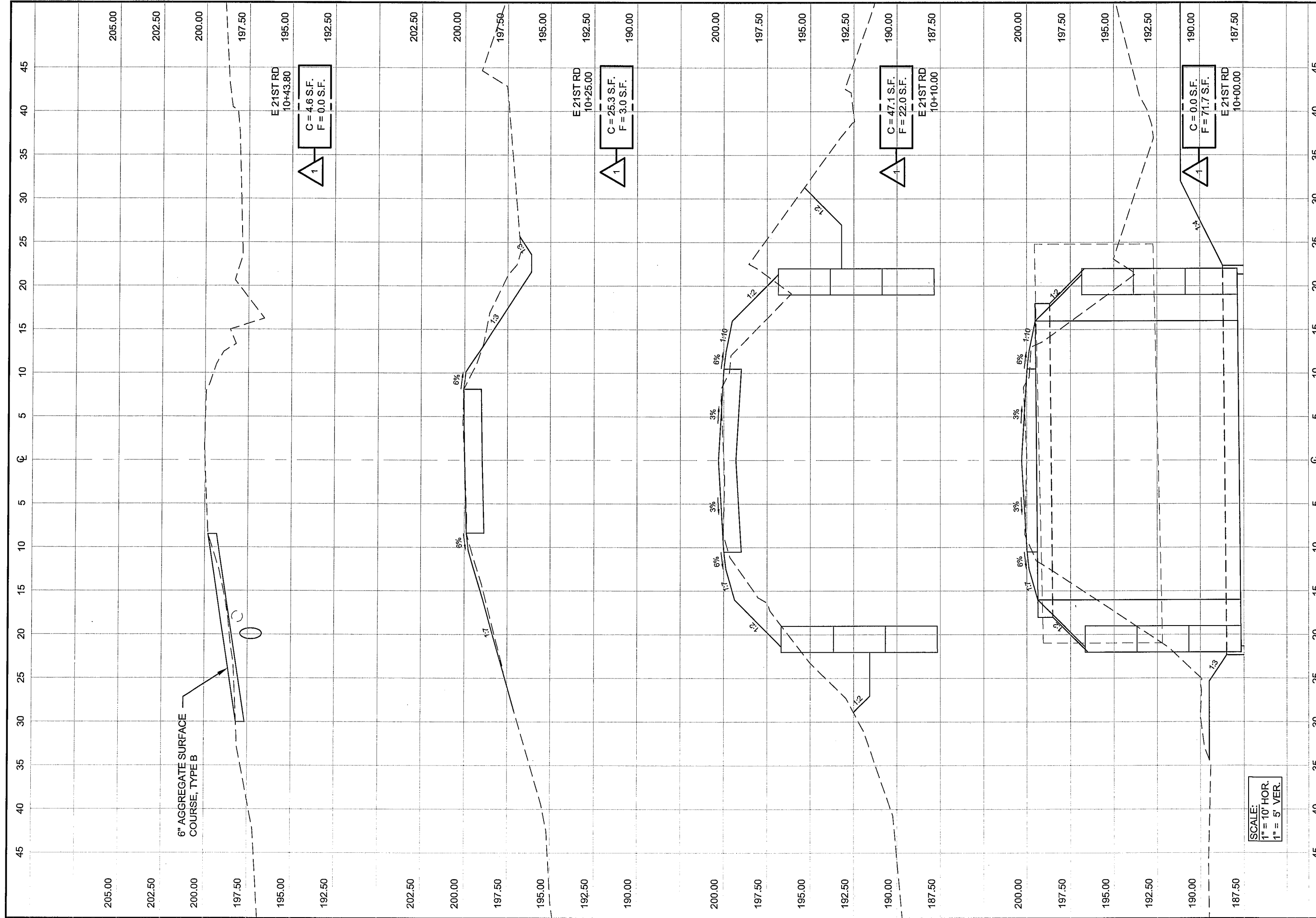

45	40	35	30	25	20	15	10	5	0	5	10	15	20	25	30	35	40	45					
205.00	202.50	200.00	197.50	195.00	192.50	202.50	200.00	197.50	195.00	192.50	190.00	200.00	197.50	195.00	192.50	190.00	187.50	200.00	197.50	195.00	192.50	190.00	187.50
6" AGGREGATE SURFACE COURSE, TYPE B																							
E 21ST RD 10+43.80										E 21ST RD 10+25.00													
C = 4.6 S.F. F = 0.0 S.F.										C = 25.3 S.F. F = 3.0 S.F.													
E 21ST RD 10+10.00										E 21ST RD 10+00.00													
C = 47.1 S.F. F = 22.0 S.F.										C = 0.0 S.F. F = 71.7 S.F.													
SCALE: 1" = 10' HOR. 1" = 5' VER.																							
LASALLE COUNTY HIGHWAYS "PLEASE DRIVE SAFELY"										LASALLE COUNTY HIGHWAY DEPARTMENT 1400 N. 27TH ROAD - P.O. BOX 128 - OTTAWA, ILLINOIS 61350 PHONE (815) 434-0743 FAX (434)-0747													
SHEET NO. 10 of 10										XSECTION H10 (2)													
HWY. NO. E 21ST RD										SECTION 24-14865-00-DR													